

MOTOR DATA @ 460 VAC (SINE)

MOTOR PARAMETERS	UNITS	VALUE
HORSEPOWER	HP	1.63
KILOWATTS	KW	1.22
MAX. OPERATING SPEED	N. MAX RPM	5000
SPEED @ RATED TORQUE	N RATED RPM	4000
* CONTINUOUS RATED TORQUE @ 4000 RPM	IN-LBS[Nm]	25.5[2.9]
* CONTINUOUS STALL TORQUE	IN-LBS[Nm]	30.0[3.4]
CONTINUOUS LINE CURRENT	AMPS[RMS/φ]	2.6
PEAK TORQUE	IN-LBS[Nm]	105.0[11.9]
PEAK CURRENT	AMPS[RMS/φ]	9.1
MAX. THEORETICAL ACCEL.	RAD/SEC ²	105,954
TORQUE SENSITIVITY	Kt [N-LBS/AMP/RMS/φ]/[Nm/AMP/RMS/φ]	11.6[1.3]
BACK EMF (LINE TO LINE)	Vrms/Krpm	73.2
D.C. RESISTANCE (P-P)	OHMS	5.52
INDUCTANCE (P-P)	MILLIHENRIES	17.4
ROTOR INERTIA	Jm [IN-LBS-SEC ²]/[Kg-M ²]	.000991[.000116]
STATIC FRICTION	Tf [IN-LBS]/[Nm]	.5[.06]

*25°C AMBIENT WITH A MAXIMUM CASE TEMPERATURE OF 100°C ON MOTOR. MOTOR MOUNTED ON A 10" X 10" X 10" X 1/4" ALUMINUM HEATSINK. THERMOSTAT IN STATOR WINDINGS WILL OPEN IF WINDING TEMPERATURE EXCEEDS 155°C. THIS ALLOWS FOR AN APPROXIMATE +10% HEADROOM IN THE CONTINUOUS TORQUE RATING BEFORE THERMOSTAT OPENS.

MECHANICAL NOTES:

- AXIAL LOAD: 25 LBS MAX
- RADIAL LOAD: 40 LBS MAX @ 1" FROM FACE
- MOTOR SEALED TO IP65.
- MOTOR WEIGHT: 10.0 LBS. [4.5 Kg]
- MOTOR FINISH: BLACK EPOXY
- MOTOR OUTPUT SHAFT: STAINLESS STEEL
- MILLIMETERS (INCHES)

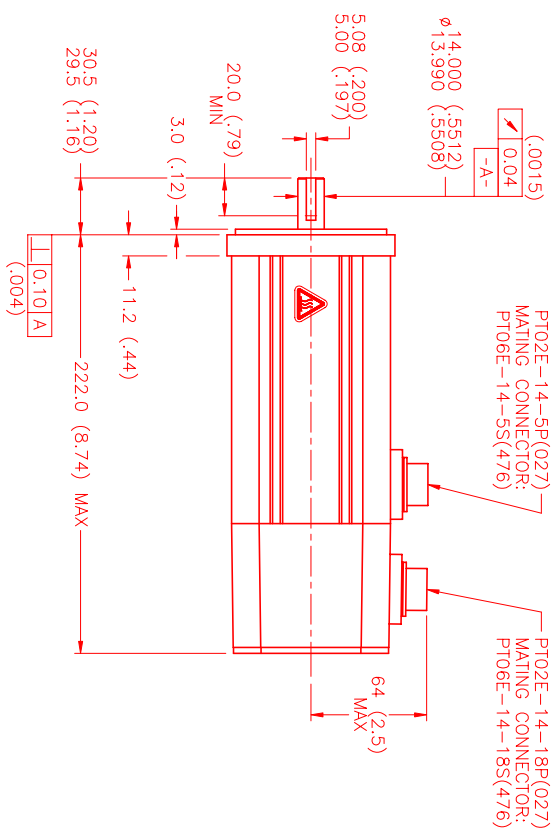
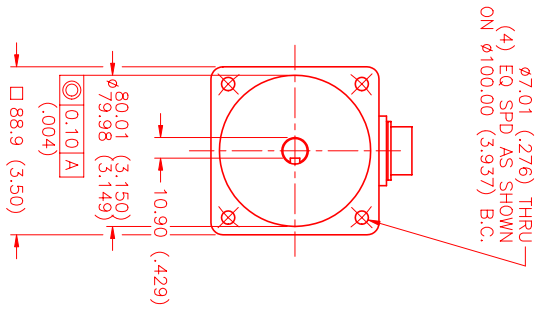

CONNECTION CHART

MOTOR CONNECTOR:
PT02E-14-5P(027)
(270-00026)

MOTOR WIRE LEADS	WIRE FUNCTION	WIRE COLOR
A	φR	RED
B	φS	BLACK
C	φT	BLUE
D	PE GND	GRN/YEL
E	-	-

RESOLVER/THERM CONNECTOR:

PT02E-14-18P(027)
(270-00024)

RES/THERM WIRE LEADS	WIRE FUNCTION	WIRE COLOR
U	THERM	BLACK
N	THERM	BLACK
H	SIN	YELLOW
G	COS GND	BLACK
S	COS	RED
F	SIN GND	BLUE
R	REF GND	YEL/WHI
E	REF	RED/WHI
D	RES SHLD	GRN/YEL
P	GND	GRN/YEL
A	-	-
B	-	-
C	-	-
J	-	-
K	-	-
L	-	-
M	-	-
T	-	-

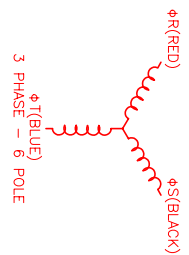
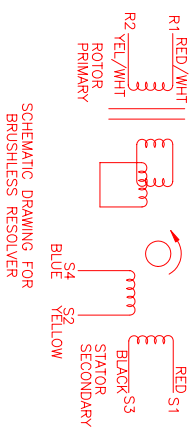

REV.	DESCRIPTION	DATE	APPD.
PRELIMINARY		8/16/99	MVS

NO.	PART NUMBER	DESCRIPTION	QTY.
1	MPM892CSJ7G1N	460VAC SINE MOTOR	1

DATE	8/16/99	TITLE	"C"/SINE/460/MET/RES/CONN
DESIGNED BY	MVS	CHECKED BY	
APPROVED BY		DRAWING NUMBER	MPM892CSJ7G1N
SCALE	1/2:1		

MTS MTS Systems Corporation
Automation Division

RESOLVER ASSEMBLY OF 85 AUTOMATION RESOLUTION IS THE PERFORMANCE OF THIS PRODUCT IS NOT GUARANTEED BY MTS SYSTEMS CORPORATION. MTS SYSTEMS CORPORATION IS NOT RESPONSIBLE FOR ANY DAMAGE TO OR LOSS OF DATA OR EQUIPMENT CAUSED BY THE USE OF THIS PRODUCT.