

### MOTOR DATA @ 230 VAC (SINE)

| MOTOR PARAMETERS                     | UNITS  | VALUE             |
|--------------------------------------|--|-------------------|
| HORSEPOWER                           | HP RATED   | 1.05              |
| KILOWATTS                            | KW RATED   | .78               |
| MAX. OPERATING SPEED                 | N. MAX RPM                                       | 3000              |
| SPEED @ RATED TORQUE                 | N RATED RPM                                      | 2400              |
| * CONTINUOUS RATED TORQUE @ 2400 RPM | IN-LBS[Nm]                                       | 27.5[3.1]         |
| * CONTINUOUS STALL TORQUE            | IN-LBS[Nm]                                       | 30.0[3.4]         |
| CONTINUOUS LINE CURRENT              | AMPS(RMS/Φ)                                      | 2.6               |
| PEAK TORQUE                          | IN-LBS[Nm]                                       | 105.0[11.9]       |
| PEAK CURRENT                         | AMPS(RMS/Φ)                                      | 9.6               |
| MAX. THEORETICAL ACCEL.              | RAD/SEC <sup>2</sup>                             | 92.025            |
| TORQUE SENSITIVITY                   | Kt [IN-LBS/AMP/RMS/ΦNm/AMP(RMS/Φ)]               | 11.6[1.31]        |
| BACK EMF (LINE TO LINE)              | Vrms/Krpm  | 73.2              |
| D.C. RESISTANCE (P-P)                | OHMS   | 6.0               |
| INDUCTANCE (P-P)                     | MILLIHENRIES                                     | 20.2              |
| ROTOR INERTIA W/ BRAKE               | Jm [IN-LBS-SEC <sup>2</sup> [Kg-M <sup>2</sup> ] | .00114[1.0001286] |
| STATIC FRICTION                      | Tf [IN-LBS[Nm]]                                  | .5[.06]           |

\*25°C AMBIENT WITH A MAXIMUM CASE TEMPERATURE OF 100°C ON MOTOR. MOTOR MOUNTED ON A 10" X 10" X 10" X 1/4" ALUMINUM HEATSINK. THERMOSTAT IN STATOR WINDINGS WILL OPEN IF WINDING TEMPERATURE EXCEEDS 155°C. THIS ALLOWS FOR AN APPROXIMATE +10% HEADROOM IN THE CONTINUOUS TORQUE RATING BEFORE THERMOSTAT OPENS.

#### MECHANICAL NOTES:

- AXIAL LOAD: 25 LBS MAX
- RADIAL LOAD: 40 LBS MAX @ 1" FROM FACE
- MOTOR SEALED TO IP65.
- MOTOR WEIGHT: 12.2 LBS. [ 5.5 Kg ]
- MOTOR FINISH: BLACK EPOXY
- MOTOR OUTPUT SHAFT: STAINLESS STEEL
- INCHES (MILLIMETERS)

#### FAIL SAFE BRAKE:

MIN HOLDING TORQUE: 60 IN-LBS  
INPUT VOLTAGE: 24 VOLTS

#### CONNECTION CHART

MOTOR/BRAKE CONNECTOR:  
PT02E-16-8P(027)  
(270-00032)

RESOLVER/THERM CONNECTOR:  
PT02E-14-18P(027)  
(270-00024)

| MOTOR/BRAKE | WIRE     | WIRE LEADS |
|-------------|----------|------------|
| PIN         | FUNCTION | WIRE COLOR |
| A           | ΦR       | RED        |
| B           | ΦS       | BLACK      |
| C           | ΦT       | BLUE       |
| D           | PE GND   | GRN/YEL    |
| E           | BRK SHLD | -          |
| F           | BRK (+)  | DIODE      |
| G           | BRK (-)  | 1N4007     |
| H           | -        | -          |

| RES/THERM | WIRE     | WIRE LEADS |
|-----------|----------|------------|
| PIN       | FUNCTION | WIRE COLOR |
| U         | THERM    | BLACK      |
| N         | THERM    | BLACK      |
| H         | SIN      | YELLOW     |
| G         | COS GND  | BLACK      |
| S         | COS      | RED        |
| F         | SIN GND  | BLUE       |
| R         | REF GND  | YEL/WHI    |
| E         | REF      | RED/WHI    |
| D         | RES SHLD | GRN/YEL    |
| P         | GND      | GRN/YEL    |
| A         | -        | -          |
| B         | -        | -          |
| C         | -        | -          |
| J         | -        | -          |
| K         | -        | -          |
| L         | -        | -          |
| M         | -        | -          |
| T         | -        | -          |

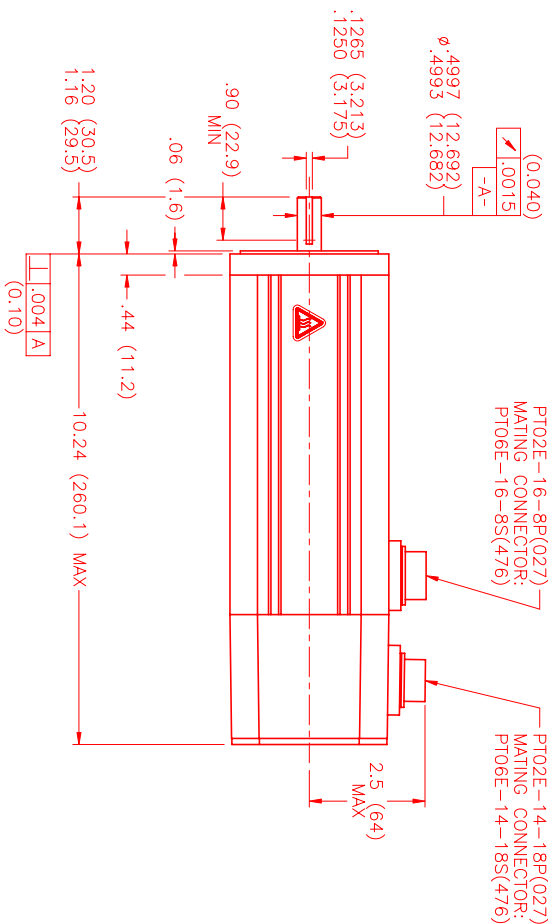
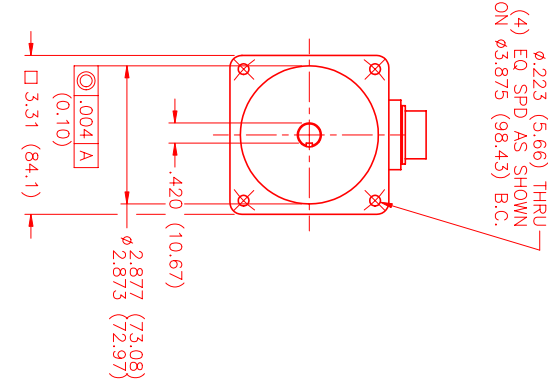

PT02E-16-8P(027)  
MATING CONNECTOR:  
PT06E-16-8S(476)

PT02E-14-18P(027)  
MATING CONNECTOR:  
PT06E-14-18S(476)

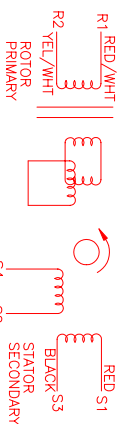

SCHEMATIC DRAWING FOR BRUSHLESS RESOLVER

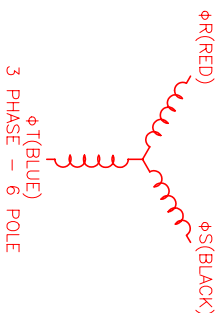

|             |             |         |        |
|-------------|-------------|---------|--------|
| REV         | DESCRIPTION | DATE    | APP'D. |
| PRELIMINARY |             | 8/24/00 | LIN    |

|     |   |             |      |
|-----|---|-------------|------|
| NO. | PART NUMBER   | DESCRIPTION | QTY. |
| 1   | UNLESS SPECIFIED  |             |      |
| 2   | DECIMAL .005 ± .005   |             |      |
| 3   | DECIMAL .010 ± .010   |             |      |
| 4   | DECIMAL .020 ± .020   |             |      |
| 5   | DECIMAL .050 ± .050   |             |      |
| 6   | DECIMAL .125 ± .125   |             |      |
| 7   | DECIMAL .250 ± .250   |             |      |
| 8   | DECIMAL .500 ± .500   |             |      |
| 9   | DECIMAL 1.000 ± 1.000   |             |      |
| 10  | DECIMAL 2.000 ± 2.000   |             |      |
| 11  | DECIMAL 5.000 ± 5.000   |             |      |
| 12  | DECIMAL 10.000 ± 10.000   |             |      |
| 13  | DECIMAL 20.000 ± 20.000   |             |      |
| 14  | DECIMAL 50.000 ± 50.000   |             |      |
| 15  | DECIMAL 100.000 ± 100.000   |             |      |
| 16  | DECIMAL 200.000 ± 200.000   |             |      |
| 17  | DECIMAL 500.000 ± 500.000   |             |      |
| 18  | DECIMAL 1000.000 ± 1000.000   |             |      |
| 19  | DECIMAL 2000.000 ± 2000.000   |             |      |
| 20  | DECIMAL 5000.000 ± 5000.000   |             |      |
| 21  | DECIMAL 10000.000 ± 10000.000   |             |      |
| 22  | DECIMAL 20000.000 ± 20000.000   |             |      |
| 23  | DECIMAL 50000.000 ± 50000.000   |             |      |
| 24  | DECIMAL 100000.000 ± 100000.000   |             |      |
| 25  | DECIMAL 200000.000 ± 200000.000   |             |      |
| 26  | DECIMAL 500000.000 ± 500000.000   |             |      |
| 27  | DECIMAL 1000000.000 ± 1000000.000   |             |      |
| 28  | DECIMAL 2000000.000 ± 2000000.000   |             |      |
| 29  | DECIMAL 5000000.000 ± 5000000.000   |             |      |
| 30  | DECIMAL 10000000.000 ± 10000000.000   |             |      |
| 31  | DECIMAL 20000000.000 ± 20000000.000   |             |      |
| 32  | DECIMAL 50000000.000 ± 50000000.000   |             |      |
| 33  | DECIMAL 100000000.000 ± 100000000.000   |             |      |
| 34  | DECIMAL 200000000.000 ± 200000000.000   |             |      |
| 35  | DECIMAL 500000000.000 ± 500000000.000   |             |      |
| 36  | DECIMAL 1000000000.000 ± 1000000000.000   |             |      |
| 37  | DECIMAL 2000000000.000 ± 2000000000.000   |             |      |
| 38  | DECIMAL 5000000000.000 ± 5000000000.000   |             |      |
| 39  | DECIMAL 10000000000.000 ± 10000000000.000   |             |      |
| 40  | DECIMAL 20000000000.000 ± 20000000000.000   |             |      |
| 41  | DECIMAL 50000000000.000 ± 50000000000.000   |             |      |
| 42  | DECIMAL 100000000000.000 ± 100000000000.000   |             |      |
| 43  | DECIMAL 200000000000.000 ± 200000000000.000   |             |      |
| 44  | DECIMAL 500000000000.000 ± 500000000000.000   |             |      |
| 45  | DECIMAL 1000000000000.000 ± 1000000000000.000   |             |      |
| 46  | DECIMAL 2000000000000.000 ± 2000000000000.000   |             |      |
| 47  | DECIMAL 5000000000000.000 ± 5000000000000.000   |             |      |
| 48  | DECIMAL 10000000000000.000 ± 10000000000000.000   |             |      |
| 49  | DECIMAL 20000000000000.000 ± 20000000000000.000   |             |      |
| 50  | DECIMAL 50000000000000.000 ± 50000000000000.000   |             |      |
| 51  | DECIMAL 100000000000000.000 ± 100000000000000.000   |             |      |
| 52  | DECIMAL 200000000000000.000 ± 200000000000000.000   |             |      |
| 53  | DECIMAL 500000000000000.000 ± 500000000000000.000   |             |      |
| 54  | DECIMAL 1000000000000000.000 ± 1000000000000000.000   |             |      |
| 55  | DECIMAL 2000000000000000.000 ± 2000000000000000.000   |             |      |
| 56  | DECIMAL 5000000000000000.000 ± 5000000000000000.000   |             |      |
| 57  | DECIMAL 10000000000000000.000 ± 10000000000000000.000                                       |             |      |
| 58  | DECIMAL 20000000000000000.000 ± 20000000000000000.000                                       |             |      |
| 59  | DECIMAL 50000000000000000.000 ± 50000000000000000.000                                       |             |      |
| 60  | DECIMAL 100000000000000000.000 ± 100000000000000000.000                                     |             |      |
| 61  | DECIMAL 200000000000000000.000 ± 200000000000000000.000                                     |             |      |
| 62  | DECIMAL 500000000000000000.000 ± 500000000000000000.000                                     |             |      |
| 63  | DECIMAL 1000000000000000000.000 ± 1000000000000000000.000                                   |             |      |
| 64  | DECIMAL 2000000000000000000.000 ± 2000000000000000000.000                                   |             |      |
| 65  | DECIMAL 5000000000000000000.000 ± 5000000000000000000.000                                   |             |      |
| 66  | DECIMAL 10000000000000000000.000 ± 10000000000000000000.000                                 |             |      |
| 67  | DECIMAL 20000000000000000000.000 ± 20000000000000000000.000                                 |             |      |
| 68  | DECIMAL 50000000000000000000.000 ± 50000000000000000000.000                                 |             |      |
| 69  | DECIMAL 100000000000000000000.000 ± 100000000000000000000.000                               |             |      |
| 70  | DECIMAL 200000000000000000000.000 ± 200000000000000000000.000                               |             |      |
| 71  | DECIMAL 500000000000000000000.000 ± 500000000000000000000.000                               |             |      |
| 72  | DECIMAL 1000000000000000000000.000 ± 1000000000000000000000.000                             |             |      |
| 73  | DECIMAL 2000000000000000000000.000 ± 2000000000000000000000.000                             |             |      |
| 74  | DECIMAL 5000000000000000000000.000 ± 5000000000000000000000.000                             |             |      |
| 75  | DECIMAL 10000000000000000000000.000 ± 10000000000000000000000.000                           |             |      |
| 76  | DECIMAL 20000000000000000000000.000 ± 20000000000000000000000.000                           |             |      |
| 77  | DECIMAL 50000000000000000000000.000 ± 50000000000000000000000.000                           |             |      |
| 78  | DECIMAL 100000000000000000000000.000 ± 100000000000000000000000.000                         |             |      |
| 79  | DECIMAL 200000000000000000000000.000 ± 200000000000000000000000.000                         |             |      |
| 80  | DECIMAL 500000000000000000000000.000 ± 500000000000000000000000.000                         |             |      |
| 81  | DECIMAL 1000000000000000000000000.000 ± 1000000000000000000000000.000                       |             |      |
| 82  | DECIMAL 2000000000000000000000000.000 ± 2000000000000000000000000.000                       |             |      |
| 83  | DECIMAL 5000000000000000000000000.000 ± 5000000000000000000000000.000                       |             |      |
| 84  | DECIMAL 10000000000000000000000000.000 ± 10000000000000000000000000.000                     |             |      |
| 85  | DECIMAL 20000000000000000000000000.000 ± 20000000000000000000000000.000                     |             |      |
| 86  | DECIMAL 50000000000000000000000000.000 ± 50000000000000000000000000.000                     |             |      |
| 87  | DECIMAL 100000000000000000000000000.000 ± 100000000000000000000000000.000                   |             |      |
| 88  | DECIMAL 200000000000000000000000000.000 ± 200000000000000000000000000.000                   |             |      |
| 89  | DECIMAL 500000000000000000000000000.000 ± 500000000000000000000000000.000                   |             |      |
| 90  | DECIMAL 1000000000000000000000000000.000 ± 1000000000000000000000000000.000                 |             |      |
| 91  | DECIMAL 2000000000000000000000000000.000 ± 2000000000000000000000000000.000                 |             |      |
| 92  | DECIMAL 5000000000000000000000000000.000 ± 5000000000000000000000000000.000                 |             |      |
| 93  | DECIMAL 10000000000000000000000000000.000 ± 10000000000000000000000000000.000               |             |      |
| 94  | DECIMAL 20000000000000000000000000000.000 ± 20000000000000000000000000000.000               |             |      |
| 95  | DECIMAL 50000000000000000000000000000.000 ± 50000000000000000000000000000.000               |             |      |
| 96  | DECIMAL 100000000000000000000000000000.000 ± 100000000000000000000000000000.000             |             |      |
| 97  | DECIMAL 200000000000000000000000000000.000 ± 200000000000000000000000000000.000             |             |      |
| 98  | DECIMAL 500000000000000000000000000000.000 ± 500000000000000000000000000000.000             |             |      |
| 99  | DECIMAL 1000000000000000000000000000000.000 ± 1000000000000000000000000000000.000           |             |      |
| 100 | DECIMAL 2000000000000000000000000000000.000 ± 2000000000000000000000000000000.000           |             |      |
| 101 | DECIMAL 5000000000000000000000000000000.000 ± 5000000000000000000000000000000.000           |             |      |
| 102 | DECIMAL 10000000000000000000000000000000.000 ± 10000000000000000000000000000000.000         |             |      |
| 103 | DECIMAL 20000000000000000000000000000000.000 ± 20000000000000000000000000000000.000         |             |      |
| 104 | DECIMAL 50000000000000000000000000000000.000 ± 50000000000000000000000000000000.000         |             |      |
| 105 | DECIMAL 100000000000000000000000000000000.000 ± 100000000000000000000000000000000.000       |             |      |
| 106 | DECIMAL 200000000000000000000000000000000.000 ± 200000000000000000000000000000000.000       |             |      |
| 107 | DECIMAL 500000000000000000000000000000000.000 ± 500000000000000000000000000000000.000       |             |      |
| 108 | DECIMAL 1000000000000000000000000000000000.000 ± 1000000000000000000000000000000000.000     |             |      |
| 109 | DECIMAL 2000000000000000000000000000000000.000 ± 2000000000000000000000000000000000.000     |             |      |
| 110 | DECIMAL 5000000000000000000000000000000000.000 ± 5000000000000000000000000000000000.000     |             |      |
| 111 | DECIMAL 10000000000000000000000000000000000.000 ± 10000000000000000000000000000000000.000   |             |      |
| 112 | DECIMAL 20000000000000000000000000000000000.000 ± 20000000000000000000000000000000000.000   |             |      |
| 113 | DECIMAL 50000000000000000000000000000000000.000 ± 50000000000000000000000000000000000.000   |             |      |
| 114 | DECIMAL 100000000000000000000000000000000000.000 ± 100000000000000000000000000000000000.000 |             |      |
| 115 | DECIMAL 200000000000000000000000000000000000.000 ± 200000000000000000000000000000000000.000 |             |      |
| 116 | DECIMAL 500000000000000000000000000000000000.000 ± 500000000000000000000000000000000000.000 |             | </   |