

MOTOR DATA @ 230 VAC (TRAP)

MOTOR PARAMETERS	UNITS	VALUE
HORSEPOWER	HP RATED	0.82
KILOWATTS	KW RATED	0.62
MAX. OPERATING SPEED	N MAX RPM	5000
SPEED @ RATED TORQUE	N RATED RPM	4000
* CONTINUOUS RATED TORQUE	IN-LBS[Nm]	13.0 [1.47]
* CONTINUOUS STALL TORQUE	IN-LBS[Nm]	16.0 [1.81]
CONTINUOUS LINE CURRENT	AMPS	3.8
PEAK TORQUE	IN-LBS[Nm]	58.8 [6.64]
PEAK CURRENT	AMPS	14.0
MAX. THEORETICAL ACCEL.	RAD/SEC ²	76,863
TORQUE SENSITIVITY	Kt [IN-LBS/AMP] [Nm/AMP]	4.2 [0.48]
BACK EMF (LINE TO LINE)	Vrms/Krpm	37.6
D.C. RESISTANCE (P-P)	OHMS	3.8
INDUCTANCE (P-P)	MILLIHENRIES	10.4
ROTOR INERTIA W/BRAKE	Jm [IN-LBS-SEC ²] [Kg-M ²]	.000765 [0.0000861]
STATIC FRICTION	Tf [IN-LBS] [Nm]	0.4 [0.05]

*25°C AMBIENT WITH A MAXIMUM CASE TEMPERATURE OF 100°C ON MOTOR. MOTOR MOUNTED ON A 10" X 10" X 10" X 1/4" ALUMINUM HEATSINK. THERMOSTAT IN STATOR WINDINGS WILL OPEN IF WINDING TEMPERATURE EXCEEDS 155°C. THIS ALLOWS FOR AN APPROXIMATE +10% HEADROOM IN THE CONTINUOUS TORQUE RATING BEFORE THERMOSTAT OPENS.

MECHANICAL NOTES:

- AXIAL LOAD: 25 LBS MAX
- RADIAL LOAD: 40 LBS MAX @ 1" FROM FACE
- MOTOR SEALED TO IP65.
- MOTOR WEIGHT: 10.3 LBS. [4.7 kg]
- MOTOR FINISH: BLACK EPOXY
- MOTOR OUTPUT SHAFT: STAINLESS STEEL
- MILLIMETERS (INCHES)

FAILSAFE BRAKE:
 MIN HOLDING TORQUE: 60 IN-LBS
 INPUT VOLTAGE: 24 VOLTS

CONNECTION CHART

MOTOR/BRAKE WIRE LEADS	WIRE FUNCTION	WIRE COLOR
S10	ΦR	RED
S15	ΦS	BLACK
S14	ΦT	BLUE
S13	ΦS	BLACK
S12	PE GND	GRN/YEL
S11	BRK (+)	BLUE
S10	BRK (-)	BLUE

RES/THERM WIRE LEADS	WIRE FUNCTION	WIRE COLOR
S9	REF GND	YEL/WHT
S8	REF	RED/WHT
S7	SIN	YELLOW
S6	COS	RED
S5	COS GND	BLACK
S4	SIN GND	BLUE
S3	THERM	BLACK
S2	THERM	BLACK
S1	GND/SHLD	GRN/YEL

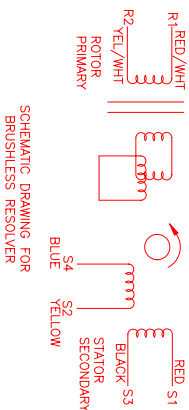
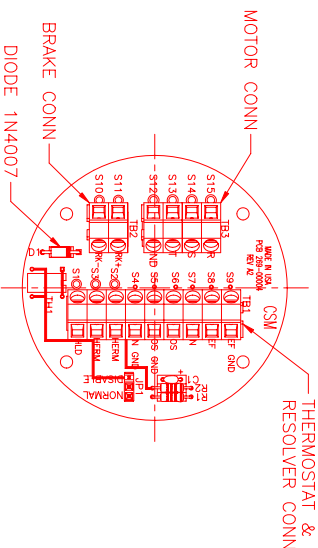

SCHEMATIC DRAWING FOR BRUSHLESS RESOLVER

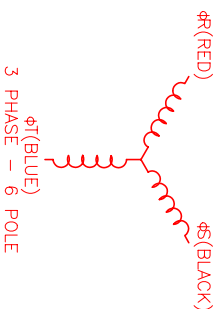
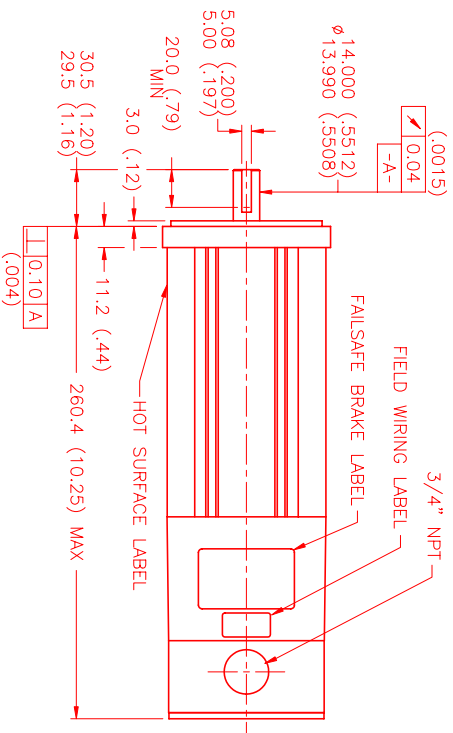
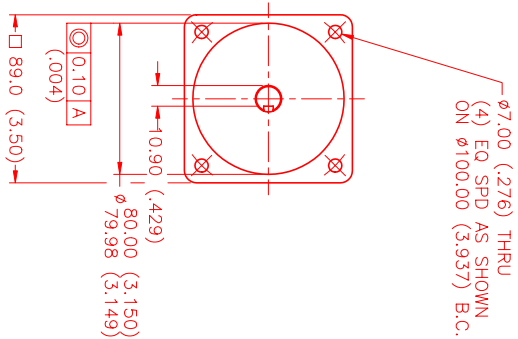

NO.	PART NUMBER	DESCRIPTION	QTY.
1	MTS	MTS Systems Corporation	
2	Automation Division		
3	MTS	MTS Systems Corporation	
4	Automation Division		
5	MTS	MTS Systems Corporation	
6	Automation Division		
7	MTS	MTS Systems Corporation	
8	Automation Division		
9	MTS	MTS Systems Corporation	
10	Automation Division		
11	MTS	MTS Systems Corporation	
12	Automation Division		
13	MTS	MTS Systems Corporation	
14	Automation Division		
15	MTS	MTS Systems Corporation	
16	Automation Division		
17	MTS	MTS Systems Corporation	
18	Automation Division		
19	MTS	MTS Systems Corporation	
20	Automation Division		
21	MTS	MTS Systems Corporation	
22	Automation Division		
23	MTS	MTS Systems Corporation	
24	Automation Division		
25	MTS	MTS Systems Corporation	
26	Automation Division		
27	MTS	MTS Systems Corporation	
28	Automation Division		
29	MTS	MTS Systems Corporation	
30	Automation Division		
31	MTS	MTS Systems Corporation	
32	Automation Division		
33	MTS	MTS Systems Corporation	
34	Automation Division		
35	MTS	MTS Systems Corporation	
36	Automation Division		
37	MTS	MTS Systems Corporation	
38	Automation Division		
39	MTS	MTS Systems Corporation	
40	Automation Division		
41	MTS	MTS Systems Corporation	
42	Automation Division		
43	MTS	MTS Systems Corporation	
44	Automation Division		
45	MTS	MTS Systems Corporation	
46	Automation Division		
47	MTS	MTS Systems Corporation	
48	Automation Division		
49	MTS	MTS Systems Corporation	
50	Automation Division		
51	MTS	MTS Systems Corporation	
52	Automation Division		
53	MTS	MTS Systems Corporation	
54	Automation Division		
55	MTS	MTS Systems Corporation	
56	Automation Division		
57	MTS	MTS Systems Corporation	
58	Automation Division		
59	MTS	MTS Systems Corporation	
60	Automation Division		
61	MTS	MTS Systems Corporation	
62	Automation Division		
63	MTS	MTS Systems Corporation	
64	Automation Division		
65	MTS	MTS Systems Corporation	
66	Automation Division		
67	MTS	MTS Systems Corporation	
68	Automation Division		
69	MTS	MTS Systems Corporation	
70	Automation Division		
71	MTS	MTS Systems Corporation	
72	Automation Division		
73	MTS	MTS Systems Corporation	
74	Automation Division		
75	MTS	MTS Systems Corporation	
76	Automation Division		
77	MTS	MTS Systems Corporation	
78	Automation Division		
79	MTS	MTS Systems Corporation	
80	Automation Division		
81	MTS	MTS Systems Corporation	
82	Automation Division		
83	MTS	MTS Systems Corporation	
84	Automation Division		
85	MTS	MTS Systems Corporation	
86	Automation Division		
87	MTS	MTS Systems Corporation	
88	Automation Division		
89	MTS	MTS Systems Corporation	
90	Automation Division		
91	MTS	MTS Systems Corporation	
92	Automation Division		
93	MTS	MTS Systems Corporation	
94	Automation Division		
95	MTS	MTS Systems Corporation	
96	Automation Division		
97	MTS	MTS Systems Corporation	
98	Automation Division		
99	MTS	MTS Systems Corporation	
100	Automation Division		