

MOTOR DATA @ 110 VAC (TRAP)

MOTOR PARAMETERS	UNITS	VALUE
HORSEPOWER	HP RATED	0.36
KILOWATTS	KW RATED	0.27
MAX. OPERATING SPEED	N. MAX RPM	5500
SPEED @ RATED TORQUE	N RATED RPM	4500
* CONTINUOUS RATED TORQUE @ 4500 RPM	IN-LBS[Nm]	5.01(.56)
* CONTINUOUS STALL TORQUE	IN-LBS[Nm]	7.5f(.85)
CONTINUOUS LINE CURRENT	AMPS	3.8
PEAK TORQUE	IN-LBS[Nm]	22.5f(2.54)
PEAK CURRENT	AMPS	11.3
MAX. THEORETICAL ACCEL.	RAD/SEC ²	175,781
TORQUE SENSITIVITY	Kt [IN-LBS/AMP] Nm/AMP	2.01(.23)
BACK EMF (LINE TO LINE)	Vrms/Krpm	17.8
D.C. RESISTANCE (P-P)	OHMS	5.2
INDUCTANCE (P-P)	MILLIHENRIES	7.0
ROTOR INERTIA	Jm [IN-LBS-SEC ²] Kg-M ²	.000128f(.0000145)
STATIC FRICTION	Tf [IN-LBS]	.65f(.073)

*25°C AMBIENT WITH A MAXIMUM CASE TEMPERATURE OF 100°C ON MOTOR. MOTOR MOUNTED ON A 10" X 10" X 1/4" ALUMINUM HEATSINK. THERMOSTAT IN STATOR WINDINGS WILL OPEN IF WINDING TEMPERATURE EXCEEDS 155°C. THIS ALLOWS FOR AN APPROXIMATE +10% HEADROOM IN THE CONTINUOUS TORQUE RATING BEFORE THERMOSTAT OPENS.

MECHANICAL NOTES:

- AXIAL LOAD: 15 LBS MAX
- RADIAL LOAD: 20 LBS MAX @ 1" FROM FACE
- MOTOR SEALED TO IP65.
- MOTOR WEIGHT: 3.1 LBS. [1.4 kg]
- MOTOR FINISH: BLACK EPOXY
- MOTOR OUTPUT SHAFT: STAINLESS STEEL
- INCHES (MILLIMETERS)

ENCODER: (290-00056) OHS35-2000P4-L6-SV

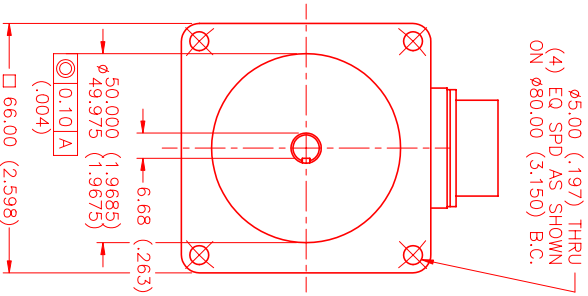

(4) EQ. SPD. AS SHOWN ON Ø80.00 (3.150) B.C.

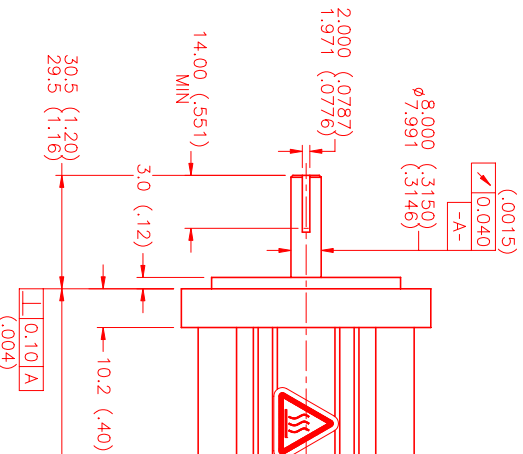

CONNECTION CHART MOTOR/ENCODER/THERM CONNECTOR: PT02E-16-23P(027) (270-00219)

ENC/THERM	WIRE	WIRE LEADS
PIN	FUNCTION	WIRE COLOR
T	GROUND	BLACK
E	+5VDC	RED
F	CH A	BLUE
U	CH A	BLUE/BLK
G	CH B	GREEN
V	CH B	GRN/BLK
H	CH Z	YELLOW
W	CH Z	YEL/BLK
J	CH U	BROWN
K	CH U	BRN/BLK
X	CH V	GRAY
L	CH V	GRAY/BLK
Y	CH W	WHITE
M	CH W	WHT/BLK
N	GND/CABLE	SHLD
S	THERM	BLACK
R	THERM	BLACK
P	-	-
Z	-	-

MOTOR WIRE LEADS		
PIN	WIRE FUNCTION	WIRE COLOR
A	φR	RED
B	φS	BLACK
C	φT	BLUE
D	PE_GND	GRN/YEL

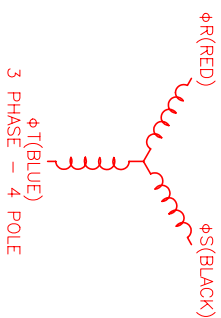

MOTOR & HALL POSITION CHART

HALL LEADS	BROWN	GRAY	WHITE
MOTOR LEADS	BLACK respect to RED	RED respect to BLUE	BLUE respect to BLACK

*MOTOR ROTATION C/W (COUNTER CLOCKWISE) (LOOKING AT THE FACE OF THE MOTOR)

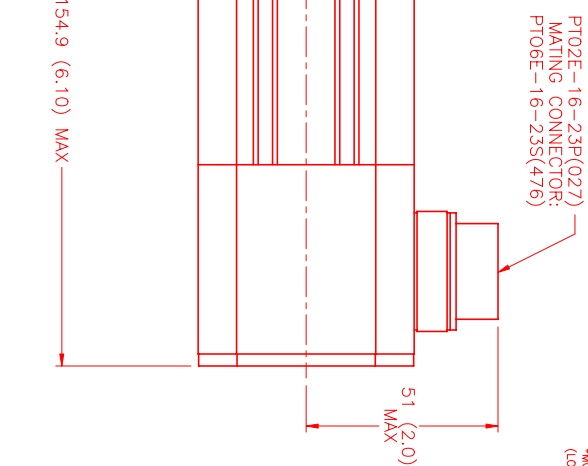

REV.	DESCRIPTION	DATE	APP.
PRELIMINARY		4/12/00	LIN

NO.	PART NUMBER	DESCRIPTION	QTY.
1	MPS	MPS Systems Corporation Automation Division	

DATE: 11/25/98	TITLE: "A" /TRAP /110/MET /TZ /CONN
CHECKED: MVS	DRAWN: MPM663ATF7JUN1N
APPROVED:	SCALE: 1:1