

### MOTOR DATA @ 95 VAC (TRAP)

MOTOR PARAMETERS	UNITS	VALUE
HORSEPOWER	HP	.18
KILOWATTS	KW	.14
MAX. OPERATING SPEED	N. MAX RPM	4000
SPEED @ RATED TORQUE	N RATED RPM	3200
* CONTINUOUS RATED TORQUE @ 3200 RPM	IN-LBS[Nm]	3.6[0.41]
* CONTINUOUS STALL TORQUE	IN-LBS[Nm]	5.0[0.56]
CONTINUOUS LINE CURRENT	AMPS	2.5
PEAK TORQUE	IN-LBS[Nm]	15.0[1.7]
PEAK CURRENT	AMPS	7.4
MAX. THEORETICAL ACCEL.	RAD/SEC <sup>2</sup>	154,639
TORQUE SENSITIVITY	Kt [IN-LBS/AMP] [Nm/AMP]	2.0[0.23]
BACK EMF (LINE TO LINE)	Vrms/Krpm	18.0
D.C. RESISTANCE (P-P)	OHMS	8.4
INDUCTANCE (P-P)	MILLIHENRIES	11.6
ROTOR INERTIA	Jm [IN-LBS-SEC <sup>2</sup> ] [Kg-M <sup>2</sup> ]	0.000097[0.0000109]
STATIC FRICTION	Tf [IN-LBS] [Nm]	0.5[0.06]

\*25°C AMBIENT WITH A MAXIMUM CASE TEMPERATURE OF 100°C ON MOTOR. MOTOR MOUNTED ON A 10" X 10" X 1/4" ALUMINUM HEATSINK. THERMOSTAT IN STATOR WINDINGS WILL OPEN IF WINDING TEMPERATURE EXCEEDS 155°C. THIS ALLOWS FOR AN APPROXIMATE +10% HEADROOM IN THE CONTINUOUS TORQUE RATING BEFORE THERMOSTAT OPENS.

#### MECHANICAL NOTES:

- AXIAL PLAY: 15 LBS MAX
- RADIAL PLAY: 20 LBS MAX @ 1" FROM FACE
- MOTOR SEALED TO IP65.
- MOTOR WEIGHT: 2.8 LBS. [ 1.3 kg]
- MOTOR FINISH: BLACK EPOXY
- MOTOR OUTPUT SHAFT: STAINLESS STEEL
- MILLIMETERS (INCHES)

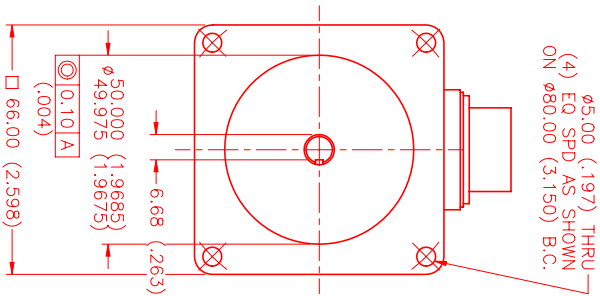

(4) EQ. SPD. AS SHOWN ON Ø80.00 (3.150) B.C.

### CONNECTION CHART MOTOR/THERM/RESOLVER CONNECTOR: PT02E-14-18P(027) (270-00024)

MTR/THERM/RES	WIRE FUNCTION	WIRE COLOR	WIRE LEADS
PIN			
A	ΦR	RED	
B	ΦS	BLACK	
C	ΦT	BLUE	
D	PE GND	GRN/YEL	
N	THERM	BLACK	
U	THERM	BLACK	
H	SIN	YELLOW	
G	COS GND	BLACK	
S	COS	RED	
F	SIN GND	BLUE	
R	REF GND	YEL/WHI	
E	REF	RED/WHI	
J	RES SHLD	GRN/YEL	
K	-	-	
L	-	-	
M	-	-	
P	-	-	
T	-	-	

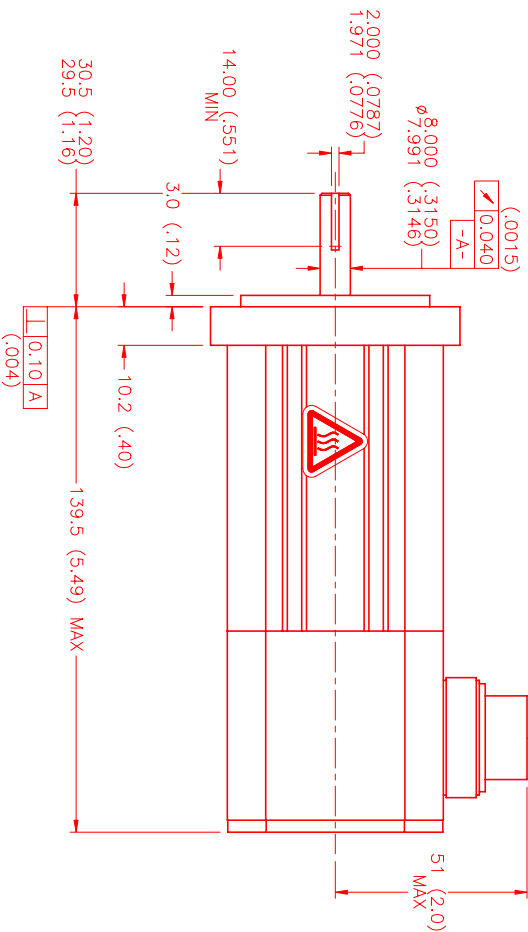

PT02E-14-18P(027)  
MATING CONNECTOR:  
PT06E-14-18S(476)

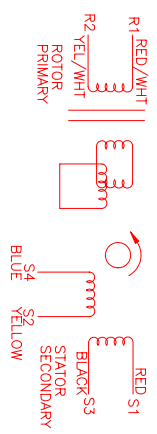
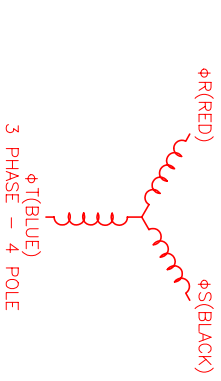

SCHEMATIC DRAWING FOR  
BRUSHLESS RESOLVER  
RESOLVER IS SET TO TBF/R AMPLIFIER

REV.	DESCRIPTION	DATE	APPD.
PRELIMINARY		6/25/01	AJS

NO.	PART NUMBER	DESCRIPTION	QTY.
UNLESS SPECIFIED			
DECIMAL ANGLES			
FRAC. ANGLES			
ANGLES			
DATE: 6/25/01			
CHECKED: AJS			
APPROVED:			
DRAWING NUMBER: MPM662ATP7H1N			
SCALE: 1:1			

MTS Automation Division